

**AI TAKAMUL COMPANY FOR ENGINEERING TESTS
AND PROFESSIONAL SAFETY LIMITED**

Basra, North Rumaila, Quality Control Yard - Iraq

Tel: +9647810009138 / +9647834964657

Email: OP@qualitycontrol-iraq.com / hany.akafi@qualitycontrol-iraq.com



CERTIFICATE OF THOROUGH EXAMINATION

This Certificate complies with the requirements of the Lifting Equipment Operations and Lifting Equipment Regulations

Date of Examination:	13/03/2025	Date of Report:	13/03/2025	Certificate No:	QC-2025-1303-13
Client Name:	HALLIBURTON	Location:	SPERRY YARD	Job Number:	130325
Last Inspection		Last Proof Load Test Date		Next Proof Load Test Due	
13/08/2024		04/09/2023		03/09/2025	

Serial Number:	QTY	Description
S. No: SDL-300A EQ No: 10849522	1	OFFSHORE BOX DIMENSION: 3.0 M (L) X 1.6 M (W) X 2.15 M (H) FULLY WELDED STEEL CONSTRUCTION WITH FOUR TOP MOUNTED LIFTING POINTS TARE WEIGHT: 2000 KG PAYLOAD: 1500 KG MAX GROSS WEIGHT: 3500 KG

Reference Standard:	BS 7072/ HAL DOC: WM-GL-HAL-HSE-0420F & WM-GL-HAL-HSE-0420C REV 1
----------------------------	-------------------------------------------------------------------

Pad Eyes Dimension:	Thickness:	Pin Hole:	Length:	Height:
	25 mm	30 mm	220 mm	125 mm

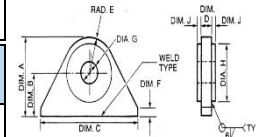

Is this the first examination after Installation or assembly at a new site or location?	YES	NO	✓	Was the examination carried out: Within an interval of 6 months?	YES	NO	✓
					With an interval of 12 months?	YES	NO
If the answer to the above question is YES has the equipment been installed correctly?	YES	NO		In accordance with an examination scheme? After the occurrence of exceptional circumstances?	YES	NO	✓
					YES	NO	✓

Identification of any part found to have a defect which is or could not become a danger to persons and a description of the defect: (If none state NONE) **NONE**

Is the above a defect which is of immediate danger to persons: YES NO

Is the above a defect which is not yet but could become a danger to persons (If YES state the date by when) N/A

Particulars of any repair, renewal or alteration required to remedy the defect identified above:

Particulars of any tests carried out as part of the examination: (If none state NONE)

** The subject Items were inspected Visually and dimensionally where no signs of defects were observed at the time of inspection and found satisfactory

** MPI was carried out on the pad eyes Welding Areas and found satisfactory

IS THIS EQUIPMENT SAFE TO OPERATE? YES NO

Name of Inspector:	Name of person authenticating this report:	Signature & Stamp:	
ASHRAF ELSAID	MOHAMED ABDALLAH		
Date of Next Through Examination:	12/09/2025		

REV: 01 Dated: 20 June 2022

THIS IS TO CERTIFY THAT; a competent person did attend the above-mentioned owner's work location on the date shown above and the equipment described in this report was tested & inspected as per the requirements of Lifting Operations Lifting Equipment Regulation "LOLER". The result was found Satisfactory at the time of Inspection and considered Safe for Lifting.



CERTIFICATION OF VISUAL, THOROUGH EXAMINATION & MAGNETIC PARTICLE INSPECTION

Client:	HALLIBURTON	Report No:	QC-2025-1303-14
Location:	SPERRY YARD	Job Number:	130325
Date:	Thursday, March 13, 2025	Next Inspection Date:	Friday, September 12, 2025
Type Of Inspection:	VISUAL, THOROUGH EXAMINATION & MAGNETIC PARTICLE INSPECTION	Specification:	ASTM E709 & ASTM E 1444 (2016) ASME V Article 7 (2019)

	<table border="1" style="width: 100%; border-collapse: collapse;"> <tr> <td style="width: 30%;">UNIT DESCRIPTION:</td> <td>OFFSHOR BOX PAD EYES AND LADDER</td> </tr> <tr> <td>UNIT S/N:</td> <td>10849522 / SDL-300A</td> </tr> <tr> <td>UNIT DIM:</td> <td>3.0 M (L) X 1.6 M (W) X 2.15 M (H)</td> </tr> <tr> <td colspan="2" style="text-align: center;">INSPECTION RESULT :</td> </tr> <tr> <td style="text-align: center;">VISUAL , THOROUGH EXAMINATION</td> <td>unit fully inspected and found free from deforms, cracks, corrosion & mechanical damage</td> </tr> <tr> <td style="text-align: center;">MAGNETIC PARTICLE INSPECTION</td> <td>Welds & forgn areas inspected and found free from cracks and other defects</td> </tr> <tr> <td style="text-align: center;">FINAL RESULTS</td> <td>unit found satisfactory and free of defects at the time of inspection</td> </tr> <tr> <td colspan="2">COMMENT:</td> </tr> <tr> <td colspan="2">Magnetic Particle Inspection With A/C Hand Yoke , Black & White Contrast</td> </tr> </table>	UNIT DESCRIPTION:	OFFSHOR BOX PAD EYES AND LADDER	UNIT S/N:	10849522 / SDL-300A	UNIT DIM:	3.0 M (L) X 1.6 M (W) X 2.15 M (H)	INSPECTION RESULT :		VISUAL , THOROUGH EXAMINATION	unit fully inspected and found free from deforms, cracks, corrosion & mechanical damage	MAGNETIC PARTICLE INSPECTION	Welds & forgn areas inspected and found free from cracks and other defects	FINAL RESULTS	unit found satisfactory and free of defects at the time of inspection	COMMENT:		Magnetic Particle Inspection With A/C Hand Yoke , Black & White Contrast	
UNIT DESCRIPTION:	OFFSHOR BOX PAD EYES AND LADDER																		
UNIT S/N:	10849522 / SDL-300A																		
UNIT DIM:	3.0 M (L) X 1.6 M (W) X 2.15 M (H)																		
INSPECTION RESULT :																			
VISUAL , THOROUGH EXAMINATION	unit fully inspected and found free from deforms, cracks, corrosion & mechanical damage																		
MAGNETIC PARTICLE INSPECTION	Welds & forgn areas inspected and found free from cracks and other defects																		
FINAL RESULTS	unit found satisfactory and free of defects at the time of inspection																		
COMMENT:																			
Magnetic Particle Inspection With A/C Hand Yoke , Black & White Contrast																			

EQUIPMENT DETAILS						PERSON DETAILS		REVIEW BY	
Equipment:	AC-Yoke Test Block	Equipment:	Digital Lux Meter	Equipment:	AC/DC Yoke	INSPECTOR NAME: ASHRAF ELSAID		SENIOR INSPECTOR:	MOHAMED ABDALLAH
S.No:	1657	S.No:	2722003	S.No:	201504052				
Cal Due Date:	11-Apr-25	Cal Due Date:	13-Apr-25	Cal Due Date:	11-Apr-25				
Black Magnetic Ink Manufacture:	Magnaflux	Batch No:	230604	Expiry Date:	MAY,2026	QUALIFICATION ASNT LEVEL II MT & PT & VT		CLIENT:	
Whie Contrast Paint Manufacture:	Magnaflux	Batch No:	230408	Expiry Date:	APRIL,2026				
Technical Details:	Magnetic Partical Concentration		Method		WMPT Light Intensity		STAMP & SIGNATURE:		
	1.2 to 2.4 ml/100 ml		Wet Magnetic Particle Testing (WMPT)		3630 Lux				
Original - Client Files		Copy - Area Office		QC/FN/MPI/065 Rev.00		DATED 07 Nov 2021			

**AI TAKAMUL COMPANY FOR ENGINEERING TESTS
AND PROFESSIONAL SAFETY LIMITED**

Basra, North Rumaila, Quality Control Yard - Iraq

Tel: +9647810009138 / +9647834964657

Email: OP@qualitycontrol-iraq.com / hany.akafi@qualitycontrol-iraq.com



CERTIFICATE OF THOROUGH EXAMINATION

This Certificate complies with the requirements of the Lifting Equipment Operations and Lifting Equipment Regulations

Date of Examination:	13/03/2025	Date of Report:	13/03/2025	Certificate No:	QC-2025-1303-15
Client Name:	HALLIBURTON	Location:	SPERRY YARD	Job Number:	130325

Serial Number:	QTY	Description	SWL	Date of manufacture if known:	Date of last thorough examination
AZ862	01	<p><u>5 LEGS WIRE ROPE SLING</u></p> <p>Manufacture: Safety Marine Master Leg DIM: 22 MM(DIA) x 1.55 M(L) S.F: 5:1 4 Leg Dim: 16 MM(DIA) x 2.2 M (L)</p> <p>IWRC, MECHANICALLY SPLICED WITH STEEL FERRULE C/W MASTER LINK ASSEMBLY HARD EYE BOTH ENDS</p>	6.2 TON at 0-45° Angle	N/A	13-08-2024

Reference Standard: BS EN 13414-1/ HAL DOC: WM-GL-HAL-HSE-0420F & WM-GL-HAL-HSE-0420C REV 1

Is this the first examination after Installation or assembly at a new site or location?	YES	NO	✓	Was the examination carried out: Within an interval of 6 months?	YES	✓	NO	
					With an interval of 12 months?	YES		NO
If the answer to the above question is YES has the equipment been installed correctly?	YES	NO		In accordance with an examination scheme? After the occurrence of exceptional circumstances?	YES	✓	NO	
					YES		NO	✓

Identification of any part found to have a defect which is or could not become a danger to persons and a description of the defect: (If none state NONE) **NONE**

Is the above a defect which is of immediate danger to persons: YES NO

Is the above a defect which is not yet but could become a danger to persons (If YES state the date by when) N/A

Particulars of any repair, renewal or alteration required to remedy the defect identified above:

Particulars of any tests carried out as part of the examination: (If none state NONE)

The subject Items were inspected Visually and dimensionally where no signs of defects were observed at the time of inspection and found satisfactory

IS THIS EQUIPMENT SAFE TO OPERATE? YES NO

Name of Inspector:	Name of person authenticating this report:	Signature & Stamp:	
ASHRAF ELSAID	MOHAMED ABDALLAH		
Date of Next Through Examination:	12/09/2025		

REV: 01 Dated: 20 June 2022

THIS IS TO CERTIFY THAT; a competent person did attend the above-mentioned owner's work location on the date shown above and the equipment described in this report was tested & inspected as per the requirements of Lifting Operations Lifting Equipment Regulation "LOLER". The result was found Satisfactory at the time of Inspection and considered Safe for Lifting.



**AI TAKAMUL COMPANY FOR ENGINEERING TESTS
AND PROFESSIONAL SAFETY LIMITED**

Basra, North Rumaila, Quality Control Yard - Iraq

Tel: +9647810009138 / +9647834964657

Email: OP@qualitycontrol-iraq.com / hany.akafi@qualitycontrol-iraq.com



CERTIFICATE OF THOROUGH EXAMINATION

This Certificate complies with the requirements of the Lifting Equipment Operations and Lifting Equipment Regulations

Date of Examination:	13/03/2025	Date of Report:	13/03/2025	Certificate No:	QC-2025-1303-16				
Client Name:	HALLIBURTON	Location:	SPERRY YARD	Job Number:	130325				
Serial Number:	QTY	Description	SWL	Date of manufacture if known:	Date of last thorough examination				
AZ874 AZ875 AZ876 AZ877	04	<u>SAFETY PIN BOW SHACKLE</u> MANUFACTURE: CROSBY SIZE: 1" GRADE: 6 S.F: 6:1	8.5 TON	N/A	13/08/2024				
Reference Standard:	BS EN 13889 / HAL DOC: WM-GL-HAL-HSE-0420F & WM-GL-HAL-HSE-0420C REV 1								
Is this the first examination after Installation or assembly at a new site or location?		<table border="1"> <tr> <td>YES</td> <td><input type="checkbox"/></td> <td>NO</td> <td><input checked="" type="checkbox"/></td> </tr> </table>		YES	<input type="checkbox"/>	NO	<input checked="" type="checkbox"/>	Was the examination carried out:	
YES	<input type="checkbox"/>	NO	<input checked="" type="checkbox"/>						
				Within an interval of 6 months?					
				YES <input checked="" type="checkbox"/> NO <input type="checkbox"/>					
				With an interval of 12 months?					
				YES <input type="checkbox"/> NO <input checked="" type="checkbox"/>					
If the answer to the above question is YES has the equipment been installed correctly?		<table border="1"> <tr> <td>YES</td> <td><input type="checkbox"/></td> <td>NO</td> <td><input type="checkbox"/></td> </tr> </table>		YES	<input type="checkbox"/>	NO	<input type="checkbox"/>	In accordance with an examination scheme?	
YES	<input type="checkbox"/>	NO	<input type="checkbox"/>						
				YES <input checked="" type="checkbox"/> NO <input type="checkbox"/>					
				After the occurrence of exceptional circumstances?					
				YES <input type="checkbox"/> NO <input checked="" type="checkbox"/>					
Identification of any part found to have a defect which is or could not become a danger to persons and a description of the defect: (If none state NONE) NONE									
Is the above a defect which is of immediate danger to persons:				YES	<input type="checkbox"/>				
Is the above a defect which is not yet but could become a danger to persons (If YES state the date by when)				N/A	<input type="checkbox"/>				
Particulars of any repair, renewal or alteration required to remedy the defect identified above:									
Particulars of any tests carried out as part of the examination: (If none state NONE)									
The subject Items were inspected Visually and dimensionally where no signs of defects were observed at the time of inspection and found satisfactory									
IS THIS EQUIPMENT SAFE TO OPERATE?				YES	<input checked="" type="checkbox"/>				
Name of Inspector:		Name of person authenticating this report:		Signature & Stamp:					
ASHRAF ELSAID		MOHAMED ABDALLAH							
Date of Next Through Examination:		12/09/2025							

REV: 01 Dated: 20 June 2022

THIS IS TO CERTIFY THAT; a competent person did attend the above-mentioned owner's work location on the date shown above and the equipment described in this report was tested & inspected as per the requirements of Lifting Operations Lifting Equipment Regulation "LOLER". The result was found Satisfactory at the time of Inspection and considered Safe for Lifting.

