

**AI TAKAMUL COMPANY FOR ENGINEERING TESTS
AND PROFESSIONAL SAFETY LIMITED**

Basra, North Rumaila, Quality Control Yard - Iraq

Tel: +9647810009138 / +9647834964657

Email: OP@qualitycontrol-iraq.com / hany.akafi@qualitycontrol-iraq.com



CERTIFICATE OF THOROUGH EXAMINATION

This Certificate complies with the requirements of the Lifting Equipment Operations and Lifting Equipment Regulations

Date of Examination:	04/09/2024	Date of Report:	04/09/2024	Certificate No:	QC-2024-0409-07
Client Name:	HALLIBURTON	Location:	SPERRY YARD	Job Number:	040924
Last Inspection		Last Proof Load Test Date		Next Proof Load Test Due	
31/05/2023		31/05/2023		30/05/2025	

Serial Number:	QTY	Description
13079108	1	<p align="center">WORKSHOP CONTAINER</p> <p>DIM: 3.16 M (L) X 2.43 M (W) X 2.60 M (H)</p> <p>FULLY WELDED STEEL CONSTRUCTION WITH FOUR TOP MOUNTED LIFTING POINTS</p> <p>TARE WEIGHT: 2200 KG</p> <p>PAYLOAD: 1500 KG</p> <p>MAX. GROSS WEIGHT: 3700 KG</p>

Reference Standard:	BS 7072/ HAL DOC: WM-GL-HAL-HSE-0420F & WM-GL-HAL-HSE-0420C REV 1
----------------------------	---

Pad Eyes Dimension:	Thickness:	Pin Hole:	Length:	Height:
	35 mm	28 mm	184 mm	96 mm

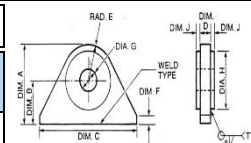

Is this the first examination after Installation or assembly at a new site or location?	YES		NO	✓	Was the examination carried out: Within an interval of 6 months? With an interval of 12 months? In accordance with an examination scheme? After the occurrence of exceptional circumstances?	YES	✓	NO	
	YES		NO			YES	✓	NO	✓
If the answer to the above question is YES has the equipment been installed correctly?	YES		NO			YES	✓	NO	
	YES		NO			YES		NO	✓

Identification of any part found to have a defect which is or could not become a danger to persons and a description of the defect: (If none State NONE) **NONE**

Is the above a defect which is of immediate danger to persons: YES NO

Is the above a defect which is not yet but could become a danger to persons (If YES state the date by when) N/A

Particulars of any repair, renewal or alteration required to remedy the defect identified above:

Particulars of any tests carried out as part of the examination: (If none state NONE)

**** The subject Items were inspected Visually and dimensionally where no signs of defects were observed at the time of inspection and found satisfactory**

**** MPI was carried out on the pad eyes Welding Areas and found satisfactory**

IS THIS EQUIPMENT SAFE TO OPERATE? YES NO

Name of Inspector:	Name of person authenticating this report:	Signature & Stamp:	
ASHRAF ELSAID	MOHAMED ABDALLAH		
Date of Next Through Examination:	03/03/2025		

REV: 01 Dated: 20 June 2022

THIS IS TO CERTIFY THAT; a competent person did attend the above-mentioned owner's work location on the date shown above and the equipment described in this report was tested & inspected as per the requirements of Lifting Operations Lifting Equipment Regulation "LOLER". The result was found Satisfactory at the time of Inspection and considered Safe for Lifting.



CERTIFICATION OF VISUAL, THOROUGH EXAMINATION & MAGNETIC PARTICLE INSPECTION

Client:	HALLIBURTON	Report No:	QC-2024-0409-07A
Location:	SPERRY YARD	Job Number:	40924
Date:	04.SEPT.2024	Next Inspection Date:	03.MARCH.2025
Type Of Inspection:	VISUAL , THOROUGH EXAMINATION & MAGNETIC PARTICLE INSPECTION	Specification:	ASTM E709 & ASTM E 1444 (2016) ASME V Article 7 (2019)
		UNIT DESCRIPTION:	WORKSHOP CONTAINER PADEYES & ATTACHED LADDER
		UNIT S/N:	13079108
		UNIT DIM:	3.16 M (L) X 2.43 M (W) X 2.60 M (H)
		VISUAL , THOROUGH EXAMINATION	unit fully inspected and found free from deforms, cracks, corrosion & mechanical damage
		MAGNETIC PARTICLE INSPECTION	Welds & forgn areas inspected and found free from cracks and other defects
		FINAL RESULTS	unit found satisfactory and free of defects at the time of inspection
COMMENT:			
Magnetic Particle Inspection With A/C Hand Yoke , Black & White Contrast			

EQUIPMENT DETAILS						PERSON DETAILS		REVIEW BY	
Equipment:	AC-Yoke Test Block	Equipment:	Digital Lux Meter	Equipment:	AC/DC Yoke	INSPECTOR NAME: ASHRAF ELSAID		SENIOR INSPECTOR:	MOHAMED ABDALLAH
S.No:	1657	S.No:	2722003	S.No:	201504052			QUALIFICATION ASNT LEVEL II MT & PT & VT	SUPERVISOR:
Cal Due Date:	16-Oct-24	Cal Due Date:	14-Oct-24	Cal Due Date:	16-Oct-24	STAMP & SIGNATURE:		CLIENT:	
Black Magnetic Ink Manufacture:	Magnaflux	Batch No:	220605	Expiry Date:	JULY.2025				
Whie Contrast Paint Manufacture:	Magnaflux	Batch No:	220602	Expiry Date:	JUN,2025				
Technical Details:	Magnetic Partical Concentration		Method		WMPT Light Intensity				
	1.2 to 2.4 ml/100 ml		Wet Magnetic Particle Testing (WMPT)		3560 Lux				

Original - Client+B27:BI36 Files Copy - Area Office QC/FN/MPI/065 Rev.00 DATED 07 Nov 2021

**AI TAKAMUL COMPANY FOR ENGINEERING TESTS
AND PROFESSIONAL SAFETY LIMITED**

Basra, North Rumaila, Quality Control Yard - Iraq

Tel: +9647810009138 / +9647834964657

Email: OP@qualitycontrol-iraq.com / hany.akafi@qualitycontrol-iraq.com



CERTIFICATE OF THOROUGH EXAMINATION

This Certificate complies with the requirements of the Lifting Equipment Operations and Lifting Equipment Regulations

Date of Examination:	04/09/2024	Date of Report:	04/09/2024	Certificate No:	QC-2024-0409-10
Client Name:	HALLIBURTON	Location:	SPERRY YARD	Job Number:	040924
Serial Number:	QTY	Description	SWL	Date of manufacture if known:	Date of last thorough examination
224	01	<p align="center"><u>SAFETY PIN BOW SHACKLE</u></p> <p>SIZE: 1"</p> <p>GRADE:6</p> <p>MANUFACTURE: DY</p> <p>S.F: 6:1</p>	8.5 TON	N/A	31/05/2023
Reference Standard:		BS EN 13889 / HAL DOC: WM-GL-HAL-HSE-0420F & WM-GL-HAL-HSE-0420C REV 1			
Is this the first examination after Installation or assembly at a new site or location?		YES	NO	√	Was the examination carried out: Within an interval of 6 months?
If the answer to the above question is YES has the equipment been installed correctly?		YES	NO	√	With an interval of 12 months?
		YES	NO	√	In accordance with an examination scheme?
		YES	NO	√	After the occurrence of exceptional circumstances?
Identification of any part found to have a defect which is or could not become a danger to persons and a description of the defect: (If none state NONE) NONE					
Is the above a defect which is of immediate danger to persons:				YES	NO
Is the above a defect which is not yet but could become a danger to persons (If YES state the date by when)				N/A	
Particulars of any repair, renewal or alteration required to remedy the defect identified above:					
Particulars of any tests carried out as part of the examination: (If none state NONE)					
The subject Items were inspected Visually and dimensionally where no signs of defects were observed at the time of inspection and found satisfactory					
IS THIS EQUIPMENT SAFE TO OPERATE?				YES	NO
Name of Inspector:	Name of person authenticating this report:		Signature & Stamp:		
ASHRAF ELSAID	MOHAMED ABDALLAH				
Date of Next Through Examination:	03/03/2025				

REV: 01 Dated: 20 June 2022

THIS IS TO CERTIFY THAT; a competent person did attend the above-mentioned owner's work location on the date shown above and the equipment described in this report was tested & inspected as per the requirements of Lifting Operations Lifting Equipment Regulation "LOLER". The result was found Satisfactory at the time of Inspection and considered Safe for Lifting.



**AI TAKAMUL COMPANY FOR ENGINEERING TESTS
AND PROFESSIONAL SAFETY LIMITED**

Basra, North Rumaila, Quality Control Yard - Iraq

Tel: +9647810009138 / +9647834964657

Email: OP@qualitycontrol-iraq.com / hany.akafi@qualitycontrol-iraq.com



CERTIFICATE OF THOROUGH EXAMINATION

This Certificate complies with the requirements of the Lifting Equipment Operations and Lifting Equipment Regulations

Date of Examination:	04/09/2024	Date of Report:	04/09/2024	Certificate No:	QC-2024-0409-09
Client Name:	HALLIBURTON	Location:	SPERRY YARD	Job Number:	040924
Serial Number:	QTY	Description	SWL	Date of manufacture if known:	Date of last thorough examination
BH 482 BH 483 BH 485	03	<u>SAFETY PIN BOW SHACKLE</u> SIZE: 1" GRADE:6 MANUFACTURE: CROSBY S.F: 6:1	8.5 TON	N/A	31/05/2023
Reference Standard:	BS EN 13889 / HAL DOC: WM-GL-HAL-HSE-0420F & WM-GL-HAL-HSE-0420C REV 1				
Is this the first examination after Installation or assembly at a new site or location?		<input type="checkbox"/> YES <input type="checkbox"/> NO <input checked="" type="checkbox"/> ✓		Was the examination carried out: Within an interval of 6 months?	
				<input type="checkbox"/> YES <input checked="" type="checkbox"/> ✓ <input type="checkbox"/> NO <input type="checkbox"/>	
If the answer to the above question is YES has the equipment been installed correctly?		<input type="checkbox"/> YES <input type="checkbox"/> NO <input type="checkbox"/>		With an interval of 12 months?	
				<input type="checkbox"/> YES <input checked="" type="checkbox"/> ✓ <input type="checkbox"/> NO <input type="checkbox"/>	
				In accordance with an examination scheme?	
				<input type="checkbox"/> YES <input checked="" type="checkbox"/> ✓ <input type="checkbox"/> NO <input type="checkbox"/>	
				After the occurrence of exceptional circumstances?	
				<input type="checkbox"/> YES <input type="checkbox"/> NO <input checked="" type="checkbox"/> ✓	
Identification of any part found to have a defect which is or could not become a danger to persons and a description of the defect: (If none state NONE) NONE					
Is the above a defect which is of immediate danger to persons:				YES	<input type="checkbox"/>
Is the above a defect which is not yet but could become a danger to persons (If YES state the date by when)				NO	<input type="checkbox"/>
				N/A	
Particulars of any repair, renewal or alteration required to remedy the defect identified above:					
Particulars of any tests carried out as part of the examination: (If none state NONE)					
The subject Items were inspected Visually and dimensionally where no signs of defects were observed at the time of inspection and found satisfactory					
IS THIS EQUIPMENT SAFE TO OPERATE?				YES	<input checked="" type="checkbox"/>
				NO	<input type="checkbox"/>
Name of Inspector:	Name of person authenticating this report:		Signature & Stamp:		
ASHRAF ELSAID	MOHAMED ABDALLAH				
Date of Next Through Examination:	03/03/2025				

REV: 01 Dated: 20 June 2022

THIS IS TO CERTIFY THAT; a competent person did attend the above-mentioned owner's work location on the date shown above and the equipment described in this report was tested & inspected as per the requirements of Lifting Operations Lifting Equipment Regulation "LOLER". The result was found Satisfactory at the time of Inspection and considered Safe for Lifting.



**AI TAKAMUL COMPANY FOR ENGINEERING TESTS
AND PROFESSIONAL SAFETY LIMITED**

Basra, North Rumaila, Quality Control Yard - Iraq

Tel: +9647810009138 / +9647834964657

Email: OP@qualitycontrol-iraq.com / hany.akafi@qualitycontrol-iraq.com



CERTIFICATE OF THOROUGH EXAMINATION

This Certificate complies with the requirements of the Lifting Equipment Operations and Lifting Equipment Regulations

Date of Examination:	04/09/2024	Date of Report:	04/09/2024	Certificate No:	QC-2024-0409-08
Client Name:	HALLIBURTON	Location:	SPERRY YARD	Job Number:	040924
Serial Number:	QTY	Description	SWL	Date of manufacture if known:	Date of last thorough examination
BH 464	01	<p>5 LEGS WIRE ROPE SLING UPPER LEG DIM: 32 mm (Dia) x 3.20 M (L). OTHER LEGS DIM: 22 mm (Dia) x 1.80 M (L)</p> <p>MANUFACTURE: SAFETY MARINE IWRC, MECHANICALLY SPLICED WITH STEEL FERRULE C/W MASTER LINK ASSEMBLY</p> <p>HARD EYE BOTH ENDS</p> <p>S.F: 5:1</p>	11.26 TON	N/A	31/05/2023
Reference Standard:	BS EN 13414-1 / HAL DOC: WM-GL-HAL-HSE-0420F & WM-GL-HAL-HSE-0420C REV 1				
Is this the first examination after Installation or assembly at a new site or location?		<input type="checkbox"/> YES <input type="checkbox"/> NO <input checked="" type="checkbox"/>		Was the examination carried out:	
				Within an interval of 6 months?	
				<input type="checkbox"/> YES <input checked="" type="checkbox"/> NO <input type="checkbox"/>	
If the answer to the above question is YES has the equipment been installed correctly?		<input type="checkbox"/> YES <input type="checkbox"/> NO <input type="checkbox"/>		With an interval of 12 months?	
				<input type="checkbox"/> YES <input checked="" type="checkbox"/> NO <input type="checkbox"/>	
				In accordance with an examination scheme?	
				<input type="checkbox"/> YES <input checked="" type="checkbox"/> NO <input type="checkbox"/>	
				After the occurrence of exceptional circumstances?	
				<input type="checkbox"/> YES <input type="checkbox"/> NO <input checked="" type="checkbox"/>	
Identification of any part found to have a defect which is or could not become a danger to persons and a description of the defect: (If none State NONE) NONE					
Is the above a defect which is of immediate danger to persons:				<input type="checkbox"/> YES <input type="checkbox"/> NO <input checked="" type="checkbox"/>	
Is the above a defect which is not yet but could become a danger to persons (If YES state the date by when)				N/A	
Particulars of any repair, renewal or alteration required to remedy the defect identified above:					
Particulars of any tests carried out as part of the examination: (If none state NONE)					
The subject Items were inspected Visually and dimensionally where no signs of defects were observed at the time of inspection and found satisfactory					
IS THIS EQUIPMENT SAFE TO OPERATE?				<input type="checkbox"/> YES <input checked="" type="checkbox"/> NO <input type="checkbox"/>	
Name of Inspector:	Name of person authenticating this report:		Signature & Stamp:		
ASHRAF ELSAID	MOHAMED ABDALLAH				
Date of Next Through Examination:	03/03/2025				

REV: 01 Dated: 20 June 2022

THIS IS TO CERTIFY THAT; a competent person did attend the above-mentioned owner's work location on the date shown above and the equipment described in this report was tested & inspected as per the requirements of Lifting Operations Lifting Equipment Regulation "LOLER". The result was found Satisfactory at the time of Inspection and considered Safe for Lifting.

