

**AI TAKAMUL COMPANY FOR ENGINEERING TESTS  
AND PROFESSIONAL SAFETY LIMITED**

Basra, North Rumaila, Quality Control Yard - Iraq

Tel: +9647810009138 / +9647834964657

Email: [OP@qualitycontrol-iraq.com](mailto:OP@qualitycontrol-iraq.com) / [hany.akafi@qualitycontrol-iraq.com](mailto:hany.akafi@qualitycontrol-iraq.com)



**CERTIFICATE OF THOROUGH EXAMINATION**

This Certificate complies with the requirements of the Lifting Equipment Operations and Lifting Equipment Regulations

<b>Date of Examination:</b>	<b>25.AUG.2024</b>	<b>Date of Report:</b>	<b>25.AUG.2024</b>	<b>Certificate No:</b>	QC-Hall-2024-0320/06
<b>Client Name:</b>	HALLIBURTON -TSS	<b>Location:</b>	TSS-WORKSHOPE	<b>Job Number:</b>	QC-Hall-2024-0320

<b>Last Inspection</b>	<b>Last Proof Load Test Date</b>	<b>Next Proof Load Test Due</b>
<b>08.APR.2024</b>	<b>18.MAY.2023</b>	<b>17.MAY.2025</b>

Serial Number:	QTY	Description	SWL
PR04	01	<p align="center"><b>PIPE RACK PAD EYES</b></p> <p><b>DIMENTION:</b> 3.50 M (L) X 1.60 M (W) X 2.90 M (H)</p> <p>FULLY WELDED STEEL CONSTRUCTION WITH FOUR TOP MOUNTED LIFTING POINTS</p> <p><b>TARE WEIGHT:</b> 1500 KG</p> <p><b>MAX. GROSS WEIGHT:</b> 5500 KG</p>	4000 KG

<b>Reference Standard:</b>	<b>BS 7072/ HAL DOC: WM-GL-HAL-HSE-0420F &amp; WM-GL-HAL-HSE-0420C REV 1</b>
----------------------------	--

<b>Pad Eyes Dimension:</b>	<b>Thickness:</b>	<b>Pin Hole:</b>	<b>Length:</b>	<b>Height:</b>
	20 MM	34 MM	120 MM	250 MM

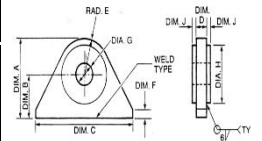

Is this the first examination after Installation or assembly at a new site or location?	YES	NO	√	Was the examination carried out: Within an interval of 6 months?	YES	NO	√
					With an interval of 12 months?	YES	NO
If the answer to the above question is YES has the equipment been installed correctly?	YES	NO	√	In accordance with an examination scheme? After the occurrence of exceptional circumstances?	YES	NO	√
					YES	NO	√

Identification of any part found to have a defect which is or could not become a danger to persons and a description of the defect: (If none state NONE)  
**NONE**

Is the above a defect which is of immediate danger to persons: YES NO √

Is the above a defect which is not yet but could become a danger to persons (If YES state the date by when) N/A

Particulars of any repair, renewal or alteration required to remedy the defect identified above:

Particulars of any tests carried out as part of the examination: (If none state NONE)

**\*\* The subject Items were inspected Visually and dimensionally where no signs of defects were observed at the time of inspection and found satisfactory**

**\*\* MPI was carried out on the pad eyes Welding Areas and found satisfactory**

**IS THIS EQUIPMENT SAFE TO OPERATE?** YES √ NO

<b>Name of Inspector:</b>	<b>Name of person authenticating this report:</b>	<b>Signature &amp; Stamp:</b>	
ASHRAF ELSAID	MOHAMED ABDULLAH		
<b>Date of Next Through Examination:</b>	<b>24.FEB.2025</b>		

REV: 01 Dated: 20 June 2022

**THIS IS TO CERTIFY THAT;** a competent person did attend the above-mentioned owner's work location on the date shown above and the equipment described in this report was tested & inspected as per the requirements of Lifting Operations Lifting Equipment Regulation "LOLER". The result was found Satisfactory at the time of Inspection and considered Safe for Lifting.

