

**AI TAKAMUL COMPANY FOR ENGINEERING TESTS
AND PROFESSIONAL SAFETY LIMITED**

Basra, North Rumaila, Quality Control Yard - Iraq

Tel: +9647810009138 / +9647834964657

Email: OP@qualitycontrol-iraq.com / hany.akafi@qualitycontrol-iraq.com



CERTIFICATE OF THOROUGH EXAMINATION

This Certificate complies with the requirements of the Lifting Equipment Operations and Lifting Equipment Regulations

Date of Examination:	25.AUG.2024	Date of Report:	25.AUG.2024	Certificate No:	QC-Hall-2024-0320/04
Client Name:	HALLIBURTON -TSS	Location:	TSS-WORKSHOPE	Job Number:	QC-Hall-2024-0320

Last Inspection	Last Proof Load Test Date	Next Proof Load Test Due
08.APR.2024	18.MAY.2023	17.MAY.2025

Serial Number:	QTY	Description	SWL
11981173	01	<p align="center">PIPE RACK PAD EYES</p> <p>DIMENTION: 3.58 M (L) X 1.60 M (W) X 2.10 M (H)</p> <p>FULLY WELDED STEEL CONSTRUCTION WITH FOUR TOP MOUNTED LIFTING POINTS</p> <p>TARE WEIGHT: 1000 KG</p> <p>MAX. GROSS WEIGHT: 5000 KG</p>	4000 KG

Reference Standard:	BS 7072/ HAL DOC: WM-GL-HAL-HSE-0420F & WM-GL-HAL-HSE-0420C REV 1
----------------------------	--

Pad Eyes Dimension:	Thickness:	Pin Hole:	Length:	Height:
	20 MM	34 MM	120 MM	250 MM

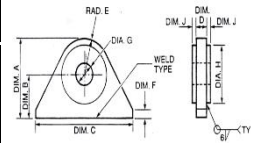

Is this the first examination after Installation or assembly at a new site or location?	YES	NO	✓	Was the examination carried out: Within an interval of 6 months?	YES	✓	NO	
					Within an interval of 12 months?	YES		NO
If the answer to the above question is YES has the equipment been installed correctly?	YES	✓	NO	In accordance with an examination scheme? After the occurrence of exceptional circumstances?	YES	✓	NO	
					YES		NO	✓

Identification of any part found to have a defect which is or could not become a danger to persons and a description of the defect: (If none Sate NONE)
NONE

Is the above a defect which is of immediate danger to persons: YES NO

Is the above a defect which is not yet but could become a danger to persons (If YES state the date by when) N/A

Particulars of any repair, renewal or alteration required to remedy the defect identified above:

Particulars of any tests carried out as part of the examination: (If none state NONE)

**** The subject Items were inspected Visually and dimensionally where no signs of defects were observed at the time of inspection and found satisfactory**

**** MPI was carried out on the pad eyes Welding Areas and found satisfactory**

IS THIS EQUIPMENT SAFE TO OPERATE? YES NO

Name of Inspector:	Name of person authenticating this report:	Signature & Stamp:	
ASHRAF ELSAID	MOHAMED ABDULLAH		
Date of Next Through Examination:	24.FEB.2025		

REV: 01 Dated: 20 June 2022

THIS IS TO CERTIFY THAT; a competent person did attend the above-mentioned owner's work location on the date shown above and the equipment described in this report was tested & inspected as per the requirements of Lifting Operations Lifting Equipment Regulation "LOLER". The result was found Satisfactory at the time of Inspection and considered Safe for Lifting.

