



ELEVATOR LINK CAT IV FULL INSPECTION CERTIFICATE

Customer:	Daqing Drilling Company	Date Of Service:	09.04.2025
Type Of Inspection:	CAT IV INSPECTION	Report No:	QC-B-04-25-0166-08
Rig & Location:	DQ Rig 037	Specification:	API RP 8B - ASTM E709

PROCEDURE

Equipment :	<i>Elevator links</i>
SN :	<i>9417, 9416</i>
Ref Standard :	<i>API RP 8B</i>



The Rig Was Equipped with Elevator Links

The Following Specification

QTY	<i>1 (set)</i>
Manufacture:	<i>N/A</i>
Minimum Requirement Frequency Field Inspection (CAT IV) :	<i>After SIX MONTHS</i>
SWL:	<i>350TON</i>

Remarks:

Detailed reports are attached detailing all readings and results in -01 of 05- pages.

LEEAA & ASNT Level II Inspector Name:	SIGNATURE	Authenticating This Report:	SIGNATURE
Abdullah Mofeed		Mohammed Abdullah	





ELEVATOR LINK CAT IV FULL INSPECTION CERTIFICATE

Customer:	Daqing Drilling Company	Date Of Service:	09.04.2025
Type Of Inspection:	CAT IV INSPECTION	Report No:	QC-B-04-25-0166-08
Rig & Location:	DQ Rig 037	Specification:	API RP 8B - ASTM E709

PROCEDURE

- **The Products Have Been Inspected and Found Them Conformable to Relevant**

The Rig was equipped with. *Elevator Links* with the following specification

- 01- Visually checked for the serial number.
- 02- Links Buffing & Cleaning Done as per the requirements of qualified inspector.
- 03- Visually checked for damage, deformations or cracks of the links
- 04- Visual & MPI checked for whole links, measured the eye thickness for wear.
- 05- Checked for the measure length & checked the straightness of the links.
- 06- Down grade the links as necessary according to the measured wear to the maximum Load limit.
- 07- Checked the parts after repainted.



INSPECTION RESULT

**** Visual & MPI was carried out on the available critical areas of the Elevator Links and found Accept at the time of inspection**

**** CAT IV Inspection was carried out on An Elevator Links & found satisfactory for further use**

Remarks:

Detailed reports are attached detailing all readings and results in -02 of 05- pages.

LEEAA & ASNT Level II Inspector Name:	SIGNATURE	Authenticating This Report:	SIGNATURE
Abdullah Mofeed		Mohammed Abdullah	





ELEVATOR LINK CAT IV FULL INSPECTION CERTIFICATE

Customer:	Daqing Drilling Company	Date Of Service:	09.04.2025
Type Of Inspection:	CAT IV INSPECTION	Report No:	QC-B-04-25-0166-08
Rig & Location:	DQ Rig 037	Specification:	API RP 8B - ASTM E709

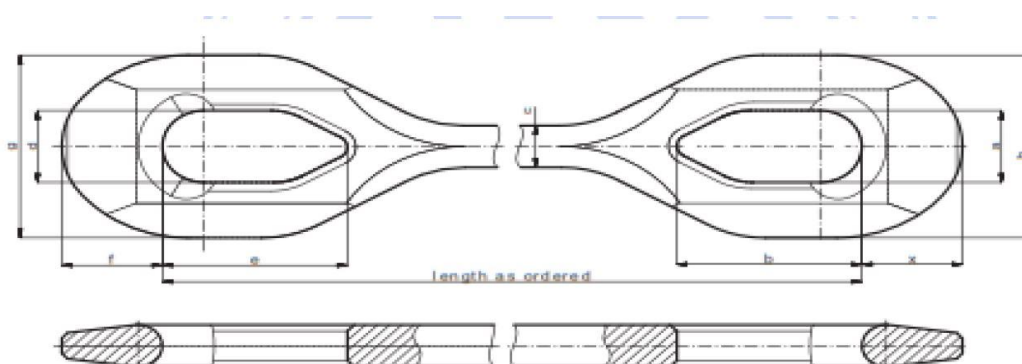

PROCEDURE



Description	S.NO: 3341	S.NO: 3343	OEM Values	Result
	Actual Value	Actual Value		
UPPER LINK WEAR POINT(f)	5 1/8"	5 1/8"	5"	ACCEPT
LOWER LINK WEAR POINT(x)	3"	3"	2 3/4"	ACCEPT
OD(c)	3 3/4"	3 3/4"	3 1/2"	ACCEPT
DIMENSION(e)UPPER LINK	10 3/4"	10 3/4"	11 3/4"	ACCEPT
DIMENSION(b)LOWER LINK	8 1/3"	8 1/3"	8 1/2"	ACCEPT

Remarks:

Detailed reports are attached detailing all readings and results in -03 of 05- pages.

LEE A & ASNT Level II Inspector Name:	SIGNATURE	Authenticating This Report:	SIGNATURE
Abdullah Mofeed		Mohammed Abdullah	



ELEVATOR LINK CAT IV FULL INSPECTION CERTIFICATE



Customer:	Daqing Drilling Company	Date Of Service:	09.04.2025
Type Of Inspection:	CAT IV INSPECTION	Report No:	QC-B-04-25-0166-08
Rig & Location:	DQ Rig 037	Specification:	API RP 8B - ASTM E709

PROCEDURE



Remarks:

Detailed reports are attached detailing all readings and results in -04 of 05- pages.

LEE A & ASNT Level II Inspector Name:	SIGNATURE	Authenticating This Report:	SIGNATURE
Abdullah Mofeed		Mohammed Abdullah	



ELEVATOR LINK CAT IV FULL INSPECTION CERTIFICATE

Customer:	Daqing Drilling Company	Date Of Service:	09.04.2025
Type Of Inspection:	CAT IV INSPECTION	Report No:	QC-B-04-25-0166-08
Rig & Location:	DQ Rig 037	Specification:	API RP 8B - ASTM E709



Remarks:
Detailed reports are attached detailing all readings and results in -05 of 05- pages.

LEE A & ASNT Level II Inspector Name:	SIGNATURE	Authenticating This Report:	SIGNATURE
Abdullah Mofeed		Mohammed Abdullah	